

TYPHOON TOOLS

FULL STRENGTH. GUARANTEED.



2014 PRODUCT CATALOGUE

CONTENTS

TOOL KITS	01
TOOL STORAGE	08
TOOL CHESTS & ROLLAWAYS	09
SITE BOXES	14
ALUMINIUM TRUCK BOXES	15
TOOLS	17
SOCKETS – SETS & INDIVIDUALS	18
SCREWDRIVERS – SETS & INDIVIDUALS	22
PLIERS – SETS & INDIVIDUALS	23
SPANNERS – SETS & INDIVIDUALS	26
ADJUSTABLE WRENCHES, PIPE WRENCHES & BOLT CUTTERS	30
TOOL BAGS	32
HEX SETS	32
MISCELLANEOUS	34
IMPACT SOCKETS 1/2" DRIVE	38
IMPACT SOCKETS 3/4" DRIVE	46
AIR TOOLS	52

Great looking tools you can rely on

Typhoon Tools really is the perfect balance of quality, price, reliability of supply and outstanding visual appeal. Attributes that are appealing to both the retailer and end user, with everybody getting more bang for their buck.

We are a wholly owned and independent Australian company with extensive experience in the wholesale tool business and we have always made it our business to know and understand the market place.

That knowledge is what has driven us to search, as we have, for the right product mix – at the right prices. Where we can combine these with our renowned approach to customer service and lifetime guarantees to complete a compelling offer to our customers.

Our objective is your satisfaction

Our ultimate objective, whether you are a retailer or the end user, is to provide you with products that are made well, look great, are priced right and are covered by a 'no-fuss' lifetime warranty. With an ever expanding product range this all makes Typhoon an easy tool brand to choose, work with and rely on!

TOOL KITS

70900B. 70900G.

188PC AF & METRIC TOOL KIT – 6 DRAWER DEEP TOOL BOX

- Available in Black or Green
- 6 Drawer Deep Tool Box
- 668 x 445 x 461mm
- 43pc 1/2" Drive Socket Set
Metric sizes: 8-32mm
AF sizes: 3/8"-1-1/4"
- 45pc 1/4" & 3/8" Drive Socket Set
1/4" drive metric sizes: 4-12mm
1/4" drive AF sizes: 3/16"-1/2"
3/8" drive metric sizes: 8-18mm
3/8" drive AF sizes: 3/8"-3/4"
- 28pc Combination Spanner Set
Metric sizes: 7-21mm
AF sizes: 1/4" to 1-1/4"
- 250mm Adjustable Wrench
- 16oz Ball Pein Hammer
- 33pc Screwdriver Set
- 30pc Hex Key Set
- 5pc Plier Set
- Top Foam Insert



70900G

70901B. 70901G.

188PC AF & METRIC TOOL KIT – 6 DRAWER TOOL BOX

- Available in Black or Green
- 6 Drawer Standard Tool Box
- 660 x 307 x 377mm
- 43pc 1/2" Drive Socket Set
Metric sizes: 8-32mm
AF sizes: 3/8"-1-1/4"
- 45pc 1/4" & 3/8" Drive Socket Set
1/4" drive metric sizes: 4-12mm
1/4" drive AF: 3/16"-1/2"
3/8" drive metric 1/4" drive: 8-18mm
3/8" drive AF sizes: 3/8"-3/4"
- 28pc Combination Spanner Set
Metric sizes: 7-21mm
AF sizes: 1/4" to 1-1/4"
- 250mm Adjustable Wrench
- 16oz Ball Pein Hammer
- 33pc Screwdriver Set
- 30pc Hex Key Set
- 5pc Plier Set
- Top Foam Insert



**ALSO
AVAILABLE
IN GREEN**

70901G

**+ GAS
STRUTS**

70901B

70902B. 70902G.

246PC AF & METRIC TOOL KIT – 13 DRAWER TOOL BOX COMBO

- Available in Black or Green
- 6 Drawer Standard Tool Box
- 7 Drawer Tool Trolley
- 43pc 1/2" Drive Socket Set
Metric sizes: 8-32mm
AF sizes: 3/8"-1-1/4"
- 45pc 1/4" & 3/8" Drive Socket Set
1/4" drive metric sizes: 4-12mm
1/4" drive AF sizes: 3/16"-1/2"
3/8" drive metric sizes: 8-18mm
3/8" drive AF sizes: 3/8"-3/4"
- 28pc Combination Spanner Set
Metric sizes: 7-21mm
AF sizes: 1/4" to 1-1/4"
- 150, 200 & 300mm Adjustable Wrenches
- 16oz Ball Pein Hammer
- 33pc Screwdriver Set
- 42pc Hex Bit Set
- 300mm Hacksaw
- 12pc Punch & Chisel Set
- 30pc Hex Key Set
- 5pc Plier Set
- Top Foam Insert



**ALSO
AVAILABLE
IN GREEN**

70902G

**+ GAS
STRUTS**

70902B

70904B. 70904G.

262PC AF & METRIC TOOL KIT

- Available in Black or Green
- 6 Drawer Deep Tool Box
- 7 Drawer Tool Trolley
- 43pc 1/2" Drive Socket Set
Metric sizes: 8-32mm
AF sizes: 3/8"-1-1/4"
- 45pc 1/4" & 3/8" Drive Socket Set
1/4" drive metric sizes: 4-12mm
1/4" drive AF sizes: 3/16"-1/2"
3/8" drive metric sizes: 8-18mm
3/8" drive AF sizes: 3/8"-3/4"
- 28pc Combination Spanner Set
Metric sizes: 7-21mm
AF sizes: 1/4" to 1-1/4"
- 150, 200 & 300mm Adjustable Wrenches
- 16oz Ball Pein Hammer
- 33pc Screwdriver Set
- 42pc Hex Bit Set
- 300mm Hacksaw
- 12pc Punch & Chisel Set
- 30pc Hex Key Set
- 5pc Plier Set
- 16pc Ratchet Ring Spanner Set
Metric sizes: 8, 10, 12, 13, 14,
16, 17 & 19mm
AF sizes: 5/6", 3/8", 7/16",
1/2", 9/16", 5/8", 11/16"
& 3/4"
- Top Foam Insert

**ALSO
AVAILABLE
IN BLACK**

70904B

**+ GAS
STRUTS**



70904G

**ALSO
AVAILABLE
IN GREEN**

70905G



70905B

**+ GAS
STRUTS**

70905B. 70905G.

268PC TOOL KIT IN 6 DRAWER TOOL BOX

- Available in Black or Green
- 6 Drawer Deep Tool Box
- 43pc 1/2" Drive Socket Set
Metric sizes: 8-32mm
AF sizes: 3/8"-1-1/4"
- 45pc 1/4" & 3/8" Drive Socket Set
1/4" drive metric sizes: 4-12mm
1/4" drive AF sizes: 3/16"-1/2"
3/8" drive metric sizes: 8-18mm
3/8" drive AF sizes: 3/8"-3/4"
- 28pc Combination Spanner Set
Metric sizes: 7-21mm
AF sizes: 1/4" to 1-1/4"
- 16oz Ball Pein Hammer
- 33pc Screwdriver Set
- 42pc Hex Bit Set
- 300mm Hacksaw
- 12pc Punch & Chisel Set
- 30 Hex Key Set
- 5pc Plier Set
- 350mm Bolt Cutter
- 350mm Steel Pipe Wrench
- 8pc Ratchet Spanner Set
Metric sizes: 8, 10, 12, 13, 14, 16,
17 & 19mm
AF sizes: 5/6", 3/8", 7/16", 1/2",
9/16", 5/8", 11/16" & 3/4"
- 18mm Ratchet Ring Spanner
- 15mm Ratchet Ring Spanner
- 150mm/6" Adjustable Wrench
- 250mm/10" Adjustable Wrench
- 300mm/12" Adjustable Wrench
- 22mm Combination Spanner
- 24mm Combination Spanner
- 27mm Combination Spanner
- 30mm Combination Spanner

70906B. 70906G.

219PC TOOL KIT IN 6 DRAWER TOOL BOX

- Available in Black or Green
- 6 Drawer Deep Tool Box
- 43pc 1/2" Drive Socket Set
- 45pc 1/4" & 3/8" Socket Set
- 1/4" Drive Socket Set
Metric sizes: 4-12mm
AF sizes: 3/16"-1/2"
- 3/8" Drive Socket Set
Metric sizes: 8-18mm
AF sizes: 3/8"-3/4"
- 1/2" Drive Socket Set
Metric sizes: 8-32mm
AF sizes: 3/8"-1-1/4"
- 28pc Combination Spanner Set
Metric sizes: 7-21mm
AF sizes: 1/4" to 1-1/4"
- 4lb Club Hammer
- 12oz Ball Pein Hammer
- 24oz Ball Pein Hammer
- 5pc Plier Set
- 12pc Punch & Chisel Set
- 9pc Hex Key Set Ball End
- 9pc Hex Key Set Ball End
- Hacksaw
- 12" Multigrips
- 16" Mutligrips
- 200mm Mini Bolt Cutter
- 32mm Combination Spanner
- 30mm Combination Spanner
- 27mm Combination Spanner
- 24mm Combination Spanner
- 22mm Combination Spanner
- 6"/150mm Adjustable Wrench
- 8"/200mm Adjustable Wrench
- 12"/300mm Adjustable Wrench
- 8pc Ratchet Spanner Set
- 15mm Ratchet Spanner
- 18mm Ratchet Spanner
- 19mm Ratchet Spanner
- 24mm Ratchet Spanner
- 33pc Screwdriver Set
- 8m/26" Tape Measure
- Internal/Straight Circlip Plier
180mm
- Internal/Bent Circlip Plier
180mm
- External/Straight Circlip Plier
180mm
- External/Bent Circlip Plier 180mm

**ALSO
AVAILABLE
IN GREEN**

70906G



70906B

**+ GAS
STRUTS**



**ALSO
AVAILABLE
IN BLACK**

70910B

70910G

70910B. 70910G.

414PC AF/METRIC TOOL KIT IN A 42", 11 DRAWER ROLLER CABINET

- Available in Black or Green
- 1080 x 1000 x 460mm
- 42" Tool Trolley
- 45pc 1/4" & 3/8" Drive Socket Set
1/4" drive metric sizes: 4-12mm
1/4" drive AF sizes: 3/16"-1/2"
3/8" drive metric sizes: 8-18mm
3/8" drive AF sizes: 3/8"-3/4"
- 43pc 1/2" Drive Socket Set
Metric sizes: 8-32mm
AF sizes: 3/8"-1-1/4"
- 27pc 3/4" Drive Socket Set
- 28pc Spanner Set
Metric sizes: 7-21mm
AF sizes: 1/4" to 1-1/4"
- 5pc Plier Set
- 150mm Adjustable Wrench
- 200mm Adjustable Wrench
- 300mm Adjustable Wrench
- 450mm Adjustable Wrench
- 22mm Combination Spanner
- 24mm Combination Spanner
- 27mm Combination Spanner
- 30mm Combination Spanner
- 32mm Combination Spanner
- 36mm Combination Spanner
- 1 1/16" Combination Spanner
- 1 1/8" Combination Spanner
- 1 1/4" Combination Spanner
- 1 3/8" Combination Spanner
- 1 1/2" Combination Spanner
- 8pc Ratchet Spanner Set Met.
- 8pc Ratchet Spanner Set Imp.
- 15mm Ratchet Spanner
- 18mm Ratchet Spanner
- 24mm Ratchet Spanner
- 450mm Steel Pipe Wrench
- 450mm Bolt Cutter
- 30pc Hex Key Set
- 42pc Bit Set
- 12pc Punch & Chisel Set
- 16 Oz Ball Pein Hammer
- Hacksaw
- 33pc Screwdriver Set
- 110pc Tap & Die Set
- Socket Tray – 1/4", 3/8", 1/2" & 3/4" Drive

TOOL STORAGE

TOOL CHESTS & ROLLAWAYS	09
------------------------------------	-----------

SITE BOXES	14
-------------------	-----------

ALUMINIUM TRUCK BOXES	15
------------------------------	-----------

70800. 70801.

**6 DRAWER
TOOL CHEST**

- 660 x 307 x 377mm
- 24.8kg
- Ball Bearing Slides



70800



70801

70805. 70806.

7 DRAWER TOOL TROLLEY

- 840 x 680 x 460mm
- 55kg
- Ball Bearing Slides



70805



70806

70810. 70811.

**6 DRAWER
TOOL CHEST DEEP**

- 668 x 445 x 461mm
- 39kg
- Ball Bearing Slides



70810



70811

70812. 70813.

**2 DRAWER (ADD-ON)
TOOL CHEST**

- 670 x 315 x 270mm
- 16kg
- Ball Bearing Slides



70812

70814. 70815.

42" 10 DRAWER TOOL CHEST

- 1080 x 645 x 460mm
- 64.5kg
- Ball Bearing Slides



70814



70815

70816. 70817.

**42" 11 DRAWER
TOOL TROLLEY**

- 1080 x 1000 x 460mm
- 118kg
- Ball Bearing Slides



70816



70817

70823Y.

YELLOW LARGE 48" SITE BOX

- 1215 x 610 x 605mm
- 61.5kg



70850.**SMALL ALUMINIUM TRUCK BOX**

- Small 760 x 305 x 295mm
- 6kg
- 1.5mm

70851.**MEDIUM ALUMINIUM TRUCK BOX**

- Medium 1230 x 380 x 380mm
- 12kg
- 1.5mm

70852.**LARGE ALUMINIUM TRUCK BOX**

- Large 1450 x 520 x 460mm
- 19kg
- 1.5mm

70849.**ALUMINIUM TRUCK BOX 3PC COMBO SET**

- Contains 70850, 70851 & 70852



70853.

SMALL ALUMINIUM TRUCK/UTE BOX

- Small Wedge 900 x 500 x 700mm
- 25kg
- 2.5mm

70854.

MEDIUM ALUMINIUM TRUCK/UTE BOX

- Medium Wedge 1210 x 500 x 700mm
- 27kg
- 2.5mm

70855.

LARGE ALUMINIUM TRUCK/UTE BOX

- Large Wedge 1450 x 500 x 700mm
- 30kg
- 2.5mm



70854



70855

RIGHT 70858. LEFT 70859.

ALUMINIUM UNDER TRAY UTE BOX

- 745 x 250 x 400mm
- 7.5kg
- 2.5mm
- Left and Right Sides Available



70858

TOOLS

SOCKETS – SETS & INDIVIDUALS	18
SCREWDRIVERS – SETS & INDIVIDUALS	22
PLIERS – SETS & INDIVIDUALS	23
SPANNERS – SETS & INDIVIDUALS	26
ADJUSTABLE WRENCHES, PIPE WRENCHES & BOLT CUTTERS	30
TOOL BAGS	32
HEX SETS	32

70000.

43PC 1/2" DRIVE AF & METRIC SOCKET SET

- Metric Sizes: 8, 9, 10, 11, 12, 13, 14, 15, 16, 17, 18, 19, 20, 21, 22, 23, 24, 27, 30, 32mm
- AF Sizes: 3/8, 7/16, 1/2, 9/16, 5/8, 11/16, 13/16, 7/8, 15/16, 1, 1-1/16, 1-1/8 & 1-1/4"
- Ratchet
- 380mm Flex Bar
- 75, 125 & 250mm Extensions
- Uni-Joint
- 2 x Adaptors
- 5/8" & 13/16" Plug Socket



70010.

45PC 1/4" & 3/8" DRIVE AF & METRIC SOCKET SET

- Metric Sizes: 8, 9, 10, 11, 12, 13, 14, 15, 16, 17, 18, (3/8" Drive) 4, 5, 6, 7, 8, 9, 10, 11, 12, (1/4" Drive)
- AF Sizes: 3/8, 7/16, 1/2, 9/16, 5/8, 11/16, 3/4, (3/8" Drive) 3/16, 7/32, 1/4, 9/32, 5/16, 11/32, 3/8, 7/16, 1/2 (1/4" Drive)
- 3/8" Ratchet
- Extensions 50 – 150
- Spinner Handle
- 5/8" Spark Socket
- 1/4" – 3/8" Adaptor



70015.

27PC 3/4" DRIVE AF & METRIC SOCKET SET

- Metric Sizes: 22, 24, 27, 30, 32, 36, 38, 41, 46, 50mm
- AF Sizes: 7/8, 15/16, 1", 1 1/8, 1 3/16, 1 5/16, 1 3/8, 1 7/16, 1 5/8, 1 3/4, 1 7/8, 2"
- Ratchet
- Sliding "T"
- 2 Extensions



70016.

27PC 3/4" DRIVE HEAVY DUTY AF & METRIC SOCKET SET

- Metric Sizes 22, 24, 27, 30, 32, 36, 38, 41, 46, 50mm
- AF Sizes 7/8, 15/16, 1", 1 1/8, 1 3/16, 1 5/16, 1 3/8, 1 7/16, 1 5/8, 1 3/4, 1 7/8, 2"
- Heavy Duty Chrome-Moly
- Ratchet
- Sliding "T"
- 2 Extensions



12 POINT SINGLE/DOUBLE HEX CHROME SOCKETS AF & METRIC

METRIC

70460.	1/2" Drive Socket – 8mm
70461.	1/2" Drive Socket – 9mm
70462.	1/2" Drive Socket – 10mm
70463.	1/2" Drive Socket – 11mm
70464.	1/2" Drive Socket – 12mm
70465.	1/2" Drive Socket – 13mm
70466.	1/2" Drive Socket – 14mm
70467.	1/2" Drive Socket – 15mm
70468.	1/2" Drive Socket – 16mm
70469.	1/2" Drive Socket – 17mm
70470.	1/2" Drive Socket – 18mm
70471.	1/2" Drive Socket – 19mm
70472.	1/2" Drive Socket – 20mm
70473.	1/2" Drive Socket – 21mm
70474.	1/2" Drive Socket – 22mm
70475.	1/2" Drive Socket – 23mm
70476.	1/2" Drive Socket – 24mm
70477.	1/2" Drive Socket – 27mm
70478.	1/2" Drive Socket – 30mm
70479.	1/2" Drive Socket – 32mm

AF

70480.	1/2" Drive Socket – 3/8"
70481.	1/2" Drive Socket – 7/16"
70482.	1/2" Drive Socket – 1/2"
70483.	1/2" Drive Socket – 9/16"
70484.	1/2" Drive Socket – 5/8"
70485.	1/2" Drive Socket – 11/16"
70486.	1/2" Drive Socket – 3/4"
70487.	1/2" Drive Socket – 13/16"
70488.	1/2" Drive Socket – 7/8"
70489.	1/2" Drive Socket – 15/16"
70490.	1/2" Drive Socket – 1"
70491.	1/2" Drive Socket – 1-1/8"
70492.	1/2" Drive Socket – 1-1/4"
70493.	1/2" Drive Socket – 1-1/4"



70440.

1/2" DRIVE BANJO RATCHET



70441.

1/2" DRIVE FLEXHANDLE 375mm



70445.

1/2" DRIVE UNI JOINT

1/2" DRIVE EXTENSIONS

- 70442. 1/2" Drive Extension 75mm
- 70443. 1/2" Drive Extension 125mm
- 70444. 1/2" Drive Extension 250mm



1/2" DRIVE ADAPTORS

- 70446. 1/2" Drive Adaptor 1/2" Female – 3/8" Male
- 70447. 1/2" Drive Adaptor 1/2" Male – 3/8" Female

1/2" DRIVE SPARK PLUG SOCKETS

- 70448. 1/2" Drive Spark Plug Socket 5/8"
- 70449. 1/2" Drive Spark Plug Socket 13/16"



70448



70449

70200.

33PC SCREWDRIVER & BIT SET

- 6 x Blade
- 6 x PH
- 1 x Bit Holder
- 20 Assorted Bits
- Blow Mould Case



INDIVIDUAL SCREWDRIVERS

BLADE

70210. 6.5 x 38mm

70211. 3.0 x 75mm

70212. 5.5 x 75mm

70213. 6.5 x 100mm

70214. 6.5 x 150mm

70215. 8.0 x 200mm

PHILLIPS

70220. No2 x 38mm

70221. No0 x 75mm

70222. No1 x 75mm

70223. No2 x 100mm

70224. No2 x 150mm

70225. No3 x 150mm



70700.

**COMBINATION
PLIERS**

- 200mm/8"
- Chrome Nickel
- Insulated Handle



70701.

**COMBINATION
PLIERS**

- 200mm/8"
- Chrome Nickel
- Thin Style Handle



70710.

**DIAGONAL
PLIERS**

- 175mm/7"
- Chrome Nickel
- Insulated Handle



70720.

**LONG NOSE
PLIERS**

- 200mm/8"
- Chrome Nickel
- Insulated Handle



70730.

**LOCKING
PLIERS**

- 250mm/10"
- Chrome Vanadium
- Insulated Handle



CIRCLIP PLIERS

- 180mm
- Chrome Vanadium

70725 180mm Internal/Straight

70726 180mm External/Straight

70727 180mm Internal/Bent

70728 180mm External/Bent

- 220mm
- Chrome Vanadium

70735 220mm Internal/Straight

70736 220mm External/Straight

70737 220mm Internal/Bent

70738 220mm External/Bent

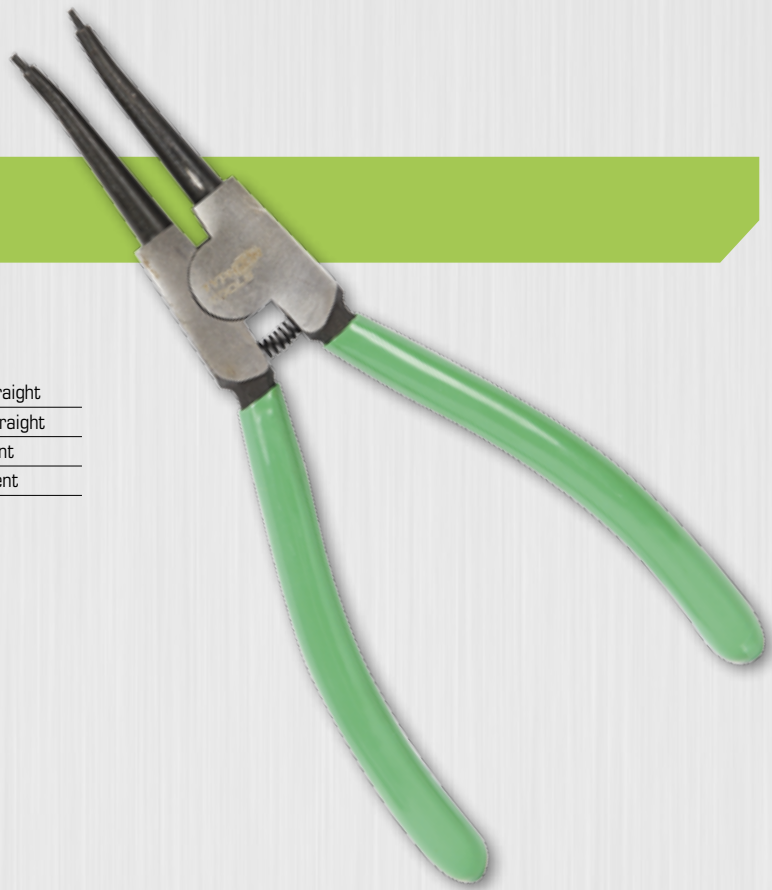

70740.

MULTIGRIPS 10"

- 10"/250mm
- Chrome Nickel
- Insulated Handle



70741.

MULTIGRIPS 12"

- 12"/300mm
- Chrome Nickel
- Insulated Handle



70742.

MULTIGRIPS 16"

- 16"/400mm
- Chrome Nickel
- Insulated Handle



70750.

5PC PLIER SET

- 200mm Combination Pliers
- 175mm Diagonal Pliers
- 200mm Long Nose Pliers
- 250mm Locking Pliers
- 250mm Multigrips
- Chrome Nickel
- Insulated Handles



70021.

8PC RATCHET SPANNER SET METRIC

- 8, 10, 12, 13, 14, 16, 17 & 19mm



70022.

8PC RATCHET SPANNER SET AF

- 5/6", 3/8", 7/16", 1/2", 9/16", 5/8", 11/16" & 3/4"



INDIVIDUAL RATCHET RING SPANNERS METRIC

70031.	8mm	70040.	17mm
70032.	9mm	70030.	18mm
70033.	10mm	70041.	19mm
70034.	11mm	70042.	21mm
70035.	12mm	70044.	23mm
70036.	13mm	70045.	24mm
70037.	14mm	70048.	27mm
70038.	15mm	70051.	30mm
70039.	16mm	70053.	32mm



70041

INDIVIDUAL COMBINATION SPANNERS AF & METRIC

• Chrome Vanadium

METRIC

70320.	7mm
70321.	8mm
70322.	9mm
70323.	10mm
70324.	11mm
70325.	12mm
70326.	13mm
70327.	14mm
70328.	15mm
70329.	16mm
70330.	17mm
70331.	18mm
70332.	19mm
70333.	20mm
70334.	21mm
70335.	22mm
70336.	23mm
70337.	24mm
70340.	27mm
70343.	30mm
70345.	32mm
70349.	36mm
70354.	41mm
70359.	46mm
70363.	50mm

AF

70370.	1/4"
70371.	5/16"
70372.	3/8"
70373.	7/16"
70374.	1/2"
70375.	9/16"
70376.	5/8"
70377.	11/16"
70378.	3/4"
70379.	13/16"
70380.	7/8"
70381.	15/16"
70382.	1"
70383.	1 1/16"
70384.	1 1/8"
70385.	1 1/4"
70386.	1 3/8"
70387.	1 1/2"
70388.	1 5/8"
70389.	1 3/4"
70390.	1 7/8"
70391.	2"



70332

70020.

28PC COMBINATION AF & METRIC SPANNER SET

- Metric Sizes: 7, 8, 9, 10, 11, 12, 13, 14, 15, 16, 17, 18, 19, 20, 21mm
- AF Sizes: 1/4, 5/16, 3/8, 7/16, 1/2, 9/16, 5/8, 11/16, 3/4, 3/16, 7/8, 15/16, 1"
- Chrome Vanadium



70023.

15PC COMBINATION SPANNER SET

- Metric Only
- Sizes: 7, 8, 9, 10, 11, 12, 13, 14, 15, 16, 17, 18, 19, 20, 21mm
- Chrome Vanadium



70024.

7PC JUMBO COMBINATION SPANNER SET

- Metric Sizes: 22, 24, 27, 30, 32, 36 & 41mm
- Chrome Vanadium



70025.

6PC JUMBO COMBINATION SPANNER SET

- AF Sizes: 1", 1-1/16", 1-1/8", 1-1/4", 1-3/8", 1-1/2"
- Chrome Vanadium



ADJUSTABLE WRENCHES

- Chrome Vanadium

70060.	150mm/6"
70061.	200mm/8"
70062.	250mm/10"
70063.	300mm/12"
70064.	375mm/15"
70065.	450mm/18"
70066.	600mm/24"
70067.	750mm/30"



STEEL PIPE WRENCHES

70770.	350mm
70771.	450mm
70772.	600mm
70773.	900mm
70774.	1200mm



ALUMINIUM PIPE WRENCHES

70780.	350mm
70781.	450mm
70782.	600mm
70783.	900mm
70784.	1200mm



70759.

MINI BOLT CUTTERS

- 8"/200mm



BOLT CUTTERS

- Chrome Vanadium Head

70760. 350mm

70761. 450mm

70762. 600mm

70763. 900mm



70764.

REBAR CUTTER & BENDER

- 16mm



THREADED ROD CUTTERS

70765. C/W M10 Die

70766. M6 Die

70767. M8 Die

70768. M10 Die



70250.

TOOL BAG

- 410 x 220 x 260mm
- Heavy Duty Bag
- Reinforced Sides & Edges
- Plastic Padded Feet
- Bucket Type
- 27 Pocket



70251.

TOOL BAG

- 490 x 250 x 280mm
- Heavy Duty Durable Material
- Steel Swivel Handle with Soft Grip
- Rubber Feet on Base



70300.

42PC HEX, TORX, SPLINE & STAR BIT SET

30mm BIT SIZES

- Hex Bits 4, 5, 6, 7, 8, 10, 12mm
- Spline M6, M8, M10, M12
- Star T20, T25, T30, T40, T45, T50, T55, T60

75mm BIT SIZES

- Hex Bits 4, 5, 6, 7, 8, 10, 12mm
- Spline M6, M8, M10, M12
- Star T20, T25, T30, T40, T45, T50, T55, T60
- 3/8" & 1/2" Adaptors
- Chrome Vanadium



9PC LONG BALL POINT HEX KEY SET

- 220mm
- Chrome Vanadium

70612 Metric: 1.5, 2, 2.5, 3, 4, 5, 6, 8, 10mm
70613 AF: 1/16", 5/64", 3/32", 1/8", 5/32", 3/16", 1/4", 5/16", 3/8"

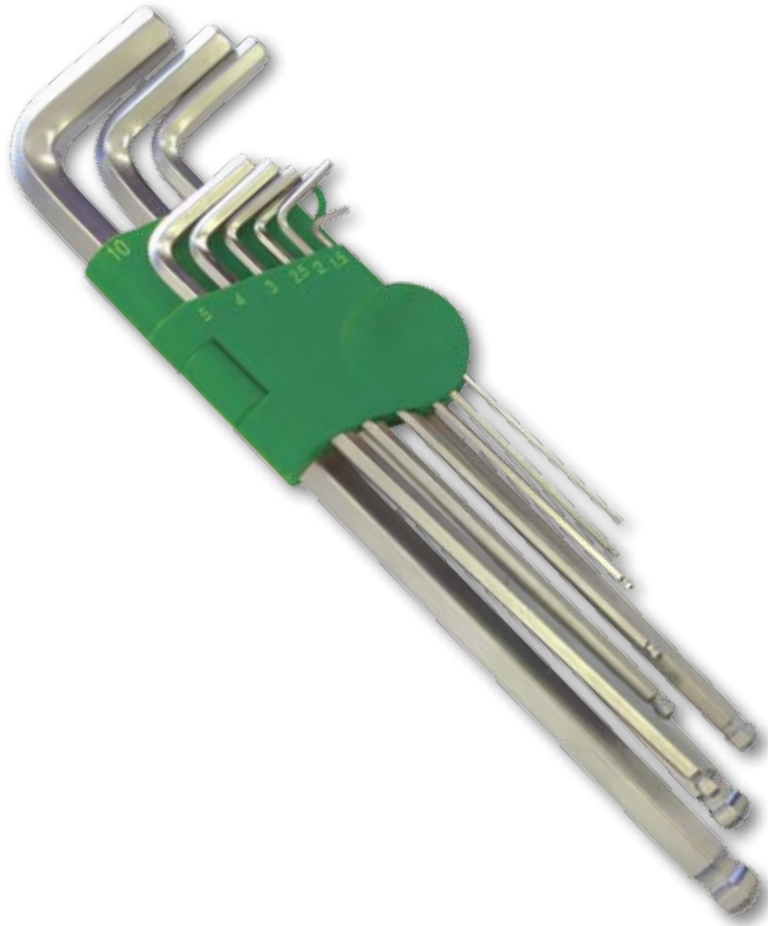

70600.

**30PC HEX KEY SET
AF & METRIC**

- 0.028" - 3/8"
- 0.7 - 10mm



MISCELLANEOUS

BALL PEIN HAMMER FIBREGLASS HANDLE

70104.	8oz
70105.	12oz
70106.	16oz
70107.	24oz
70108.	32oz
70109.	48oz



70107



70110. 4LB CLUB HAMMER

- 1pc Steel

EXTENSION LEADS

- Insulated Pins to apply to Australian Standards
- Indoor/Outdoor Use
- Neon Light for Both Pin & Plug

15AMP LEAD, 10AMP PLUG

70100.	5m
70120.	10m
70121.	15m
70122.	20m
70123.	25m
70124.	30m

15AMP LEAD, 15AMP PLUG

70127.	15m
70128.	20m
70130.	30m



SPIRIT LEVEL WITH CANVAS BAG

- 3 Vial 180°, 90°, 45°
- Accuracy 0.5mm/m
- Thickness 1.6mm
- Canvas Carry Bag
- Double Milled Surface

70150.	600mm
70151.	1200mm
70152.	1800mm

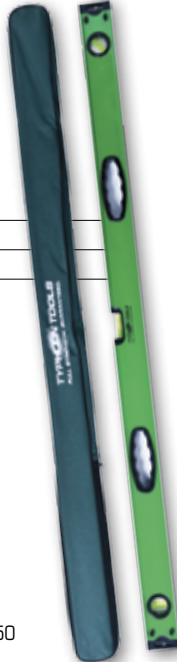

70150

TAPE MEASURE

- 25mm blade

70170.	8m/26" AF & Metric
70171.	8m Metric Only



70171

TAPE MEASURE BOX OF 10

- 25mm blade
- 8m Metric Only



70350.

110PC TAP & DIE SET UNF, UNC & METRIC

- 4-40unc, 6-32unc, 8-32unc
- 10-24unc, 10-32unf, 12-24unf
- 1/4-20unc, 1/4-28unf, 1/4-24unc
- 1/4-32unc, 5/16-18unc, 5/16-24unf
- 3/8-16unc, 3/8-24unf, 7/16-14unc
- 7/16-20unf, 1/2-13unc, 1/2-20unf
- 9/16-12unc, 9/16-18unf, 5/8-11unc
- 5/8-18unf, 3/4-10unc, 3/4-16unf
- M6 x 1.0, M8 x 1.25, M10 x 1.5, M10 x 1.0
- M11 x 1.5, M12 x 1.25, M12 x 1.75
- M14 x 1.25, M18 x 1.5
- 1/8-27npt, 1/4-18npt



70400.

HACKSAW

- 300mm



70500.

12PC PUNCH & CHISEL SET

- Pin Punch, Cold Chisel, Centre Punch & Solid Punch
- Pin punch 1.5, 3, 4, 5, 6, 8mm
- Chisel 10, 12, 16mm
- Centre Punch 6 & 8mm
- Straight Punch 2mm



70650.

4PC ADVENTURERS KIT

- Flask
- Torch
- Multipurpose Pliers
- Screwdriver Kit



70755.

188PC HOLLOW WALL ANCHOR KIT



IMPACT SOCKETS

SETS & INDIVIDUALS

**1/2" DRIVE STANDARD
IMPACT SOCKET SET**

72500 Metric 14pc 10, 11, 12, 13, 14, 15, 16, 17, 18, 19, 21, 22, 26, 27
72502 AF 13pc 7/16", 1/2", 9/16", 5/8", 11/16", 3/4", 13/16", 7/8",
 15/16", 1", 1-1/16", 1-1/8", 1-1/4"



**1/2" DRIVE DEEP
IMPACT SOCKET SET**

72501 Metric 14pc 10, 11, 12, 13, 14, 15, 16, 17, 18, 19, 21, 22, 26, 27
72503 AF 13pc 7/16", 1/2", 9/16", 5/8", 11/16", 3/4", 13/16", 7/8", 15/16", 1",
 1-1/16", 1-1/8", 1-1/4"



**8PC 1/2" DRIVE IMPACT
IN-HEX SOCKET SET**

72504 Metric 10, 11, 12, 13, 14, 15, 17, 19
72505 AF 1/4", 15/16", 3/8", 7/16", 1/2", 9/16", 5/8", 3/4"



1/2" DRIVE STANDARD LENGTH IMPACT SOCKETS, 6-POINT, METRIC



Type A



Type B



Type C

Code	Size	D1	D2	T	L	Type	
	(mm)	(mm)	(mm)	Min (mm)	(mm)		
72008	8	14	25	11	38	A	
72009	9	15.2	25	14	38		
72010	10	17.2	25	14	38		
72011	11	18.2	25	14	38		
72012	12	20	25	14	38		
72013	13	21	25	14	38		
72014	14	22.2	25	19	38		
72015	15	24	30	19	38		
72016	16	24	30	19	38		
72017	17	26	30	19	38		
72018	18	27.2	30	19	38		
72019	19	28	30	19	38		
72020	20	29.6	30	19	38		
72021	21	29.8	30	21	38		B
72022	22	31.8	30	21	38		
72023	23	33.6	30	21	38		
72024	24	33.8	30	21	38	C	
72025	25	35	30	21	38		
72026	26	35.6	30	21	38		
72027	27	37.7	30	21	40		
72028	28	39.8	30	24	43		
72029	29	39.8	30	24	43		
72030	30	41.8	30	24	43		
72032	32	43.8	30	24	43		
72033	33	44.8	30	24	46		
72034	34	45.8	30	24	46		
72035	35	47.8	30	24	50		
72036	36	49.8	30	24	50		
72038	38	51.8	30	24	50		

1/2" DRIVE STANDARD LENGTH IMPACT SOCKETS, 6-POINT, AF



Type A



Type B



Type C

Code	Size	D1	D2	T	L	Type
	(inches)	(mm)	(mm)	Min (mm)	(mm)	
72058	5/16	14	25	9	38	A
72059	3/8	17	25	9	38	
72060	7/16	18.5	25	9	38	
72061	1/2	20.5	25	9	38	
72062	9/16	23	25	11	38	
72063	5/8	24.5	30	11	38	
72064	11/16	27	30	11	38	
72065	3/4	28	30	11	38	
72066	13/16	30	30	11	38	B
72067	7/8	31.8	30	13	38	C
72068	15/16	33.8	30	13	38	
72069	1	35.8	30	13	40	
72070	1-1/16	37.8	30	13	43	
72071	1-1/8	39.8	30	16.5	43	
72072	1-3/16	41.8	30	16.5	43	
72073	1-1/4	43.8	30	16.5	43	

1/2" DRIVE DEEP LENGTH IMPACT SOCKETS, 6-POINT, METRIC



Type A

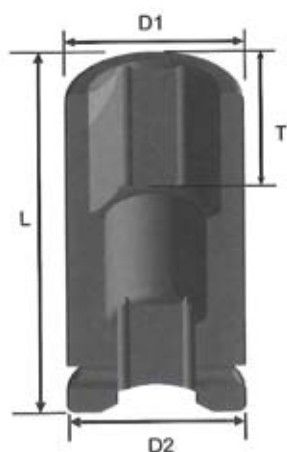

Type B



Type C

Code	Size	D1	D2	T	L	Type	
	(mm)	(mm)	(mm)	Min (mm)	(mm)		
72108	8	14	25	9	80	A	
72109	9	16.6	25	11	80		
72110	10	17	25	11	80		
72111	11	18.5	25	11	80		
72112	12	20	25	11	80		
72113	13	21	25	11	80		
72114	14	22.4	25	11	80		
72115	15	23	30	11	80		
72116	16	25	30	11	80		
72117	17	26	30	11	80		
72118	18	27.5	30	11	80		
72119	19	28.5	30	13	80		
72120	20	30	30	13	80		B
72121	21	31.9	30	13	80		C
72122	22	31.8	30	13	80		
72123	23	31.8	30	13	80		
72124	24	34.8	30	15	80		
72125	25	35.8	30	15	80		
72126	26	35.8	30	15	80		
72127	27	37.8	30	18.3	80		
72128	28	39.8	30	18.3	80		
72129	29	41.8	30	18.3	80		
72130	30	42	30	18.3	80		
72132	32	44	30	18.3	80		
72133	33	44.8	30	20	80		
72134	34	45.8	30	20	80		
72135	35	47.8	30	20	80		
72136	36	49.8	30	20	80		
72138	38	51.8	30	20	80		

1/2" DRIVE DEEP LENGTH IMPACT SOCKETS, 6-POINT, AF



Type A

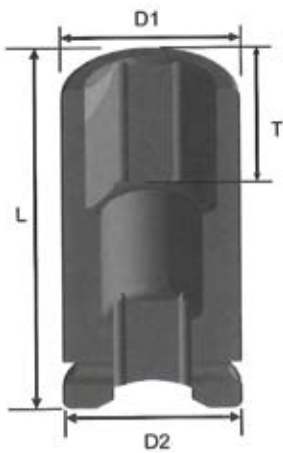

Type B



Type C

Code	Size	D1	D2	T	L	Type	
	(inches)	(mm)	(mm)	Min (mm)	(mm)		
72158	5/16	14	25	10	78	A	
72159	3/8	17	25	14	78		
72160	7/16	18.5	25	14	78		
72161	1/2	20.5	25	14	78		
72162	9/16	23	25	14	78		
72163	5/8	24.5	30	14	78		
72164	11/16	27	30	17	78		
72165	3/4	28	30	17	78		
72166	13/16	29.8	30	17	78		B
72167	7/8	31.8	30	19	78		C
72168	15/16	33.8	30	19	78		
72169	1	35.8	30	19	78		
72170	1-1/16	37.8	30	19	78		
72171	1-1/8	39.8	30	19	78		
72172	1-3/16	41.8	30	19	78		
72173	1-1/4	43.8	30	30	78		

1/2" DRIVE IMPACT IN-HEX SOCKETS, METRIC



Code	Size	D2	L
	(hex)	(mm)	(mm)
72475	5	25	78
72476	6	25	78
72477	7	25	78
72478	8	25	78
72479	10	25	78
72480	11	25	78
72481	12	25	78
72482	14	25	78
72483	17	25	78
72484	19	25	78

1/2" DRIVE IMPACT IN-HEX SOCKETS, AF



Code	Size	D2	L
	(hex)	(mm)	(mm)
72485	7/32"	25	78
72486	1/4"	25	78
72487	5/16"	25	78
72488	3/8"	25	78
72489	7/16"	25	78
72490	1/2"	25	78
72491	9/16"	25	78
72492	5/8"	25	78
72493	11/16"	25	78
72494	3/4"	25	78

1/2" DRIVE IMPACT EXTENSION BAR

72458. 1/2" Drive 75mm

72459. 1/2" Drive 125mm

72460. 1/2" Drive 250mm

72458



72450.

1/2" DRIVE IMPACT UNIVERSAL JOINT



3/4" DRIVE STANDARD LENGTH IMPACT SOCKETS, 6-POINT, METRIC



Type A

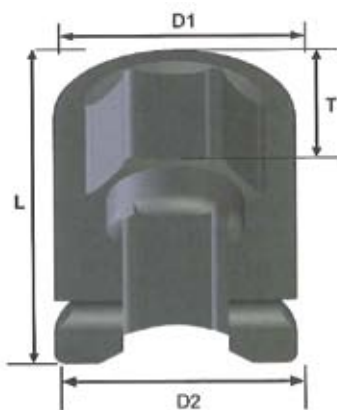

Type B



Type C

Code	Size	D1	D2	T	L	Type	
	(mm)	(mm)	(mm)	Min (mm)	(mm)		
72217	17	30	44	13	51	A	
72218	18	31	44	13	51		
72219	19	32.5	44	13	51		
72220	20	33.5	44	13	51		
72221	21	35	44	13	51		
72222	22	36	44	13	51		
72223	23	37.5	44	13	51		
72224	24	38.5	44	16	51		
72225	25	40	44	16	53		
72226	26	41	44	16	53		
72227	27	42.5	44	16	53		
72228	28	44	44	19	53		B
72229	29	45	44	19	53		
72230	30	46	44	19	53		C
72231	31	47.5	44	19	57		
72232	32	48.5	44	19	57		
72233	33	50	44	22	57		
72234	34	51	44	22	57		
72235	35	52.5	44	22	57		
72236	36	53.5	44	22	57		
72237	37	55	44	22	57		
72238	38	56	44	22	57		
72239	39	57	44	22	58		
72240	40	58.5	44	22	58		
72241	41	60	44	22	58		
72242	42	61	44	25	58		
72243	43	62.5	44	25	62		
72244	44	64	44	25	62		
72245	45	65	44	25	62		
72246	46	66	44	25	62		
72247	47	67	44	30	68		
72248	48	68	44	30	68		
72249	49	70	44	30	68		
72250	50	71	44	30	68		
72254	54	76	54	32	71		
72255	55	78	54	32	71		
72258	58	81	54	32	71		
72260	60	83.5	54	34	73		
72263	63	86	54	34	73		
72265	65	88	54	34	73		

3/4" DRIVE STANDARD LENGTH IMPACT SOCKETS, 6-POINT, AF



Type A



Type B



Type C

Code	Size	D1	D2	T	L	Type
	(inches)	(mm)	(mm)	Min (mm)	(mm)	
72275	1/2	23	41.4	13	51	A
72276	9/16	25.5	41.4	13	51	
72277	5/8	28	41.4	13	51	
72278	11/15	29.5	41.4	13	51	
72279	3/4	32	41.4	13	51	
72280	13/16	35	41.4	13	51	
72281	7/8	36	41.4	13	51	
72282	15/16	38.5	41.4	13	51	
72283	1	40	41.4	13	53	
72284	1-1/16	42.5	44	13	53	
72285	1-1/8	44	44	16	53	B
72286	1-3/16	46	44	16	53	C
72287	1-1/4	48	44	16	57	
72288	1-5/16	50	44	19	57	
72289	1-3/8	52.5	44	19	57	
72290	1-7/16	53.5	44	19	57	
72291	1-1/2	56	44	22	57	
72292	1-9/16	58.5	44	22	58	
72293	1-5/8	60	44	22	58	
72294	1-11/16	63.5	44	26	62	
72295	1-3/4	64.5	44	26	62	
72296	1-13/16	66	44	26	62	
72297	1-7/8	68	44	27	68	
72298	1-15/16	70	44	27	68	
72299	2	71	44	27	68	
72300	2-1/16	74	54	31	71	
72301	2-1/8	76	54	31	71	
72302	2-3/16	78	54	31	71	
72303	2-1/4	80	54	33	73	
72304	2-5/16	81.5	54	33	73	
72305	2-3/8	83.5	54	34	73	
72306	2-7/16	85	54	34	75	
72307	2-1/2	86.5	54	34	75	

3/4" DRIVE DEEP LENGTH IMPACT SOCKETS, 6-POINT, METRIC



Type A

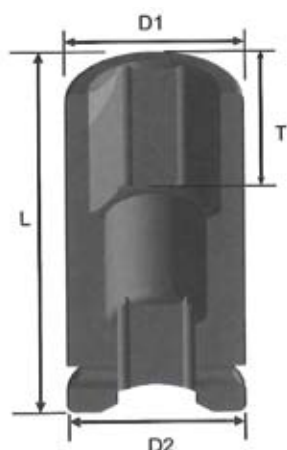

Type B



Type C

Code	Size	D1	D2	T	L	Type
	(mm)	(mm)	(mm)	Min (mm)	(mm)	
72317	17	30	44	19	90	A
72318	18	31	44	19	90	
72319	19	32.5	44	19	90	
72320	20	33.5	44	19	90	
72321	21	35	44	19	90	
72322	22	36	44	19	90	
72323	23	37.5	44	19	90	
72324	24	38.5	44	19	90	
72325	25	40	44	19	90	
72326	26	41	44	22	90	
72327	27	42.5	44	22	90	B
72328	28	44	44	22	90	
72329	29	45	44	22	90	C
72330	30	46	44	22	90	
72331	31	47.5	44	22	90	
72332	32	48.5	44	22	90	
72333	33	50	44	25	90	
72334	34	51	44	25	90	
72335	35	52.5	44	25	90	
72336	36	53.5	44	25	90	
72337	37	55	44	25	90	
72338	38	56	44	25	90	
72339	39	57	44	25	90	
72340	40	58.5	44	30	90	
72341	41	60	44	30	90	
72342	42	61	44	30	90	
72343	43	62.5	44	30	90	
72344	44	64	44	30	90	
72345	45	65	44	30	90	
72346	46	66	44	30	90	
72347	47	67	44	30	90	
72348	48	68	44	30	90	
72349	49	70	44	30	90	
72350	50	71	44	30	90	
72354	54	76	54	40	100	
72355	55	78	54	40	100	
72358	58	81	54	40	100	
72360	60	83.5	54	44	105	
72363	63	86	54	44	105	
72365	65	88	54	44	105	

3/4" DRIVE DEEP LENGTH IMPACT SOCKETS, 6-POINT, AF



Type A

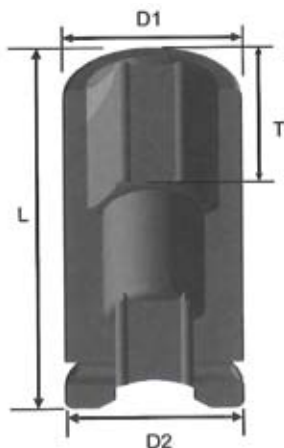

Type B



Type C

Code	Size	D1	D2	T	L	Type	
	(inches)	(mm)	(mm)	Min (mm)	(mm)		
72375	1/2	23	41.4	16	90	A	
72376	9/16	25.5	41.4	16	90		
72377	5/8	28	41.4	16	90		
72378	11/16	29.5	41.4	16	90		
72379	3/4	32	41.4	16	90		
72380	13/16	35	41.4	16	90		
72381	7/8	36	41.4	16	90		
72382	15/16	38.5	41.4	16	90		
72383	1	40	41.4	16	90		
72384	1-1/16	42.5	44	16	90		
72385	1-1/8	44	44	16	90		B
72386	1-3/16	46	44	16	90		C
72387	1-1/4	48.5	44	16	90		
72388	1-5/16	50	44	22	90		
72389	1-3/8	52.5	44	22	90		
72390	1-7/16	53.5	44	22	90		
72391	1-1/2	56	44	22	90		
72392	1-9/16	58.5	44	22	90		
72393	1-5/8	60	44	22	90		
72394	1-11/16	63.5	44	27	90		
72395	1-3/4	64.5	44	27	90		
72396	1-13/16	66	44	27	90		
72397	1-7/8	68	44	27	90		
72398	1-15/16	70	44	27	90		
72399	2	71	44	27	90		
72400	2-1/16	74	54	31	100		
72401	2-1/8	76	54	31	100		
72402	2-3/16	78	54	31	100		
72403	2-1/4	80	54	34	100		
72404	2-5/16	81.5	54	34	105		
72405	2-3/8	83.5	54	34	105		
72406	2-7/16	85	54	34	105		
72407	2-1/2	86	54	34	105		

8PC 3/4" DRIVE STANDARD IMPACT SOCKET SET

72510 Metric 27, 30, 32, 33, 35, 36, 38, 41

72512 AF 1", 1-1/16", 1-1/8", 1-1/4", 1-5/16", 1-3/8", 1-7/16", 1-1/2"



8PC 3/4" DRIVE DEEP IMPACT SOCKET SET

72511 Metric 27, 30, 32, 33, 35, 36, 38, 41

72513 AF 1", 1-1/16", 1-1/8", 1-1/4", 1-5/16", 1-3/8", 1-7/16", 1-1/2"



3/4" DRIVE IMPACT EXTENSION BAR

72461. 3/4" Drive 175mm

72462. 3/4" Drive 250mm

72462



72451.

3/4" DRIVE IMPACT UNIVERSAL JOINT



IMPACT ADAPTORS

72452. 3/8" F-1/2" M

72453. 1/2" F-3/8" M

72454. 1/2" F-3/4" M

72455. 3/4" F-1/2" M

72456. 3/4" F-1" M

72457. 1" F-3/4" M

72452



72454



AIR TOOLS

73000.

AIR ANGLED DIE GRINDER 90 DEGREE

- Collet Size: 1/4" or 6mm
- Free Speed: 20000 RPM
- Inlet (NPT): 1/4"
- Pressure (bar): 6.2
- Exhaust: Rear
- Consumption: 17 SCFM
- Weight: 0.5kg
- Length: 155mm



73001.

STRAIGHT AIR DIE GRINDER

- Collet size: 1/4" and 6mm
- Free speed: 22000 RPM
- Inlet (NPT): 1/4"
- Pressure (bar): 6.3
- Exhaust: Rear
- Consumption: 24 SCFM
- Weight: 0.6kg
- Length: 170mm



73002.

4" AIR ANGLE GRINDER

- Disc Size: 4" (100mm)
- Spindle Size: M10, M14 & 3/8"-24 UNF
- Flange of Central Hole: 16mm
- Free Speed: 11000 RPM
- Inlet (NPT): 1/4"
- Pressure (bar): 6.2
- Exhaust: Front
- Consumption: 33 SCFM
- Weight: 1.7kg
- Length: 225mm



73006.

1/2" AIR RATCHET WRENCH

- Driver Size: 1/2"
- Free Speed: 160 RPM
- Max Torque: 60ft-lb
- Gear Type: 2 Gear
- Ratchet Pawl: Single
- Inlet (NPT): 1/4"
- Pressure (bar): 6.2
- Air Consumption: 28 SCFM
- Weight: 1.25kg
- Length: 265mm



73003.

3/8" REVERSIBLE DRILL

- Chuck size 3/8"
- Free speed: 22000 RPM
- Inlet (NPT): 1/4"
- Pressure (bar): 6.3
- Exhaust: Rear
- Consumption: 24 SCFM
- Weight: 0.6kg
- Length: 170mm



73004.

1/2" REVERSIBLE AIR DRILL

- Chuck Size: 1/2"
- Free Speed: 700 RPM
- Bolt Capacity: 13mm
- Inlet (NPT): 1/4"
- Gear Type: 8 Gear
- Pressure (bar): 6.2
- Exhaust: Handle
- Consumption: 16 SCFM
- Weight: 1.62kg
- Length: 230mm



73005.

1/2" AIR IMPACT WRENCH

- Driver Size: 1/2"
- Free Speed: 7000 RPM
- Working Torque: 260ft-lbs
- Max Torque: 280ft-lbs
- Inlet (NPT): 1/4"
- Clutch Type: Rocking Dog
- Pressure (bar): 6.2
- Air Consumption: 30 SCFM
- Weight: 2.14kg
- Length: 193mm



73007.

1/2" COMPOSITE AIR IMPACT WRENCH

- Driver Size: 1/2"
- Free Speed: 7500 RPM
- Working Torque: 600ft-lb
- Max Torque: 950ft-lb
- Inlet (NPT): 1/4"
- Clutch Type: Twin Hammer
- Minimum Hose Size: 3/8"
- Air Consumption: 32 SCFM
- Weight: 2.06kg
- Length: 198mm



73008.

3/4" AIR IMPACT WRENCH

- Driver Size: 3/4"
- Free Speed: 4500 RPM
- Working Torque: 750ft-lb
- Max Torque: 800ft-lb
- Inlet (NPT): 1/4"
- Clutch Type: Pin
- Minimum Hose Size: 3/8"
- Air Consumption: 34 SCFM
- Weight: 4.86kg
- Length: 240mm



73009.

3/4" COMPOSITE AIR IMPACT WRENCH

- Driver Size: 3/4"
- Free Speed: 4500 RPM
- Working Torque: 1000ft-lb
- Max Torque: 1100ft-lb
- Inlet (NPT): 3/8"
- Clutch Type: Twin Hammer
- Minimum Hose Size: 3/8"
- Air Consumption: 40 SCFM
- Weight: 3.88kg
- Length: 240mm



73010.

3/16" AIR HYDRAULIC RIVETER

- Traction power: 885kg
- Tool stroke: 0.552" (14mm)
- Nose pieces: 2.4-3.2-4.0-4.8mm
- Avg-air consumption: 3.5 CFM
- Rivet material: Aluminum & Stainless
- Working Pressure: 60-100PSI
- Air Inlet: 1/4" PT (NPT)
- Net Weight: 1.5kg



73011.

190mm AIR HAMMER KIT

- Air Hammer
- 125mm Round Chisel
- Male Plug
- Spring Retainer
- Oil Pot
- 5x 125mm Round Chisels



73012.

6" NON-VACUUM PALM SANDER

- Pad Size: 6"
- Orbit Diameter: 5mm
- Free Speed: 10500 RPM
- Air Consumption: 26 SCFM
- Air Inlet: 1/4"
- Pressure (bar): 6.2
- Exhaust: Rear
- Weight: 0.84kg
- Length: 165mm



73013.

AIR DUSTER

- Nylon Fibre Body
- Steel, 100mm Nozzle
- Working Pressure: 5-8kg
- Max Pressure: 15kg
- Sound Pressure: 85-90 dB
- Thread: 1/4" NPT/PS Female
- Temp Range: -40 - 140°F



TYPHOON TOOLS

FULL STRENGTH. GUARANTEED.

OUR GUARANTEE OF STRENGTH

Typhoon tools have a lifetime warranty against faulty workmanship and materials.



facebook.com/typhoontoolsaustralia

www.typhoon-tools.com.au

HEAD OFFICE

Phone 03 9311 2385 Fax 03 9311 4892
44 North View Drive, Sunshine West, Victoria 3020

WESTERN AUSTRALIA

Phone 08 9258 8999 Fax 08 9358 0555
1/14 Fargo Way, Welshpool WA 6106

2014 PRODUCT CATALOGUE